

# Artemide®

## Calumet

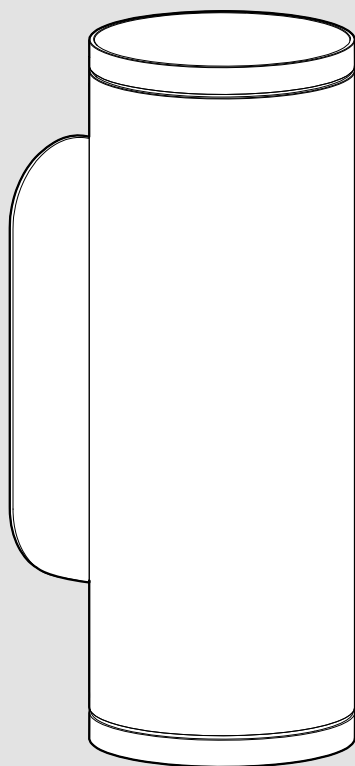



i

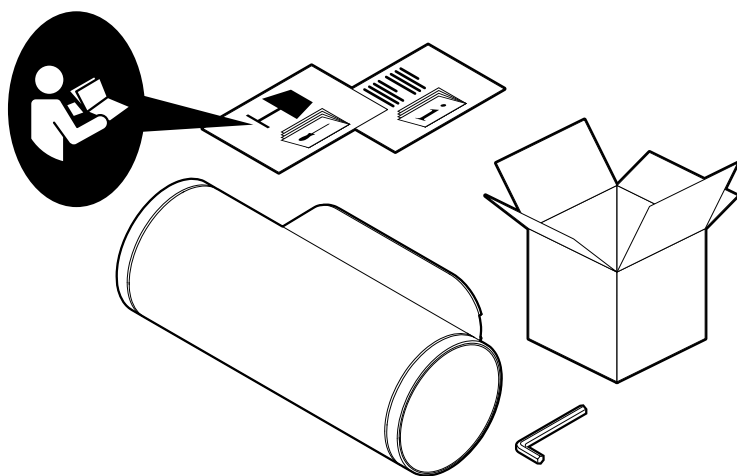

**i**

**IK06**

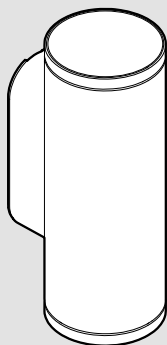

**Ø 80 mm**

**IK09**

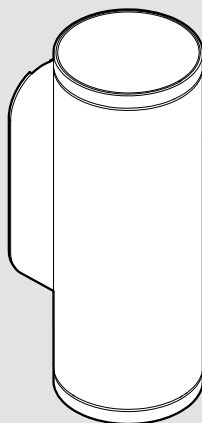

**Ø 130 mm**

**i**

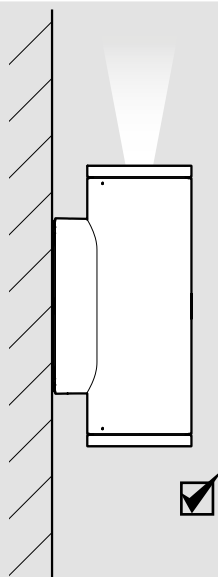
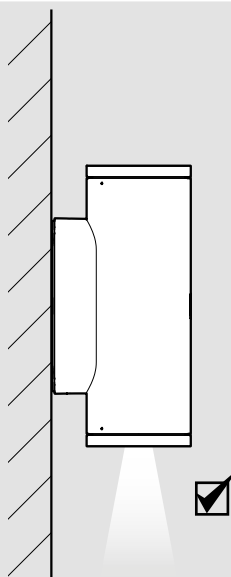
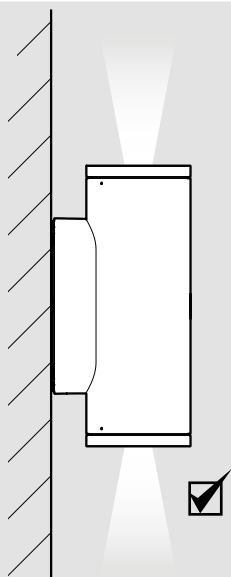

1

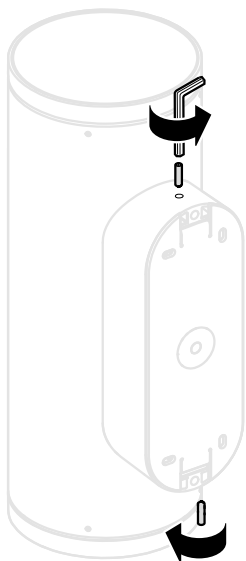

2

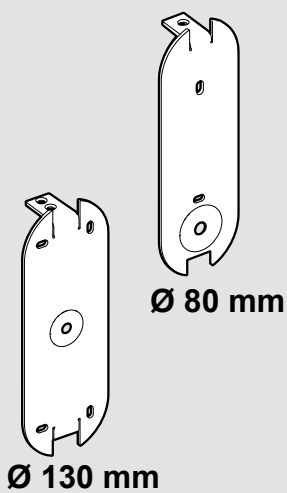
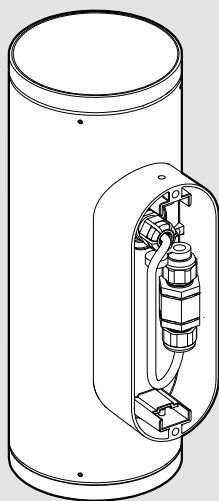
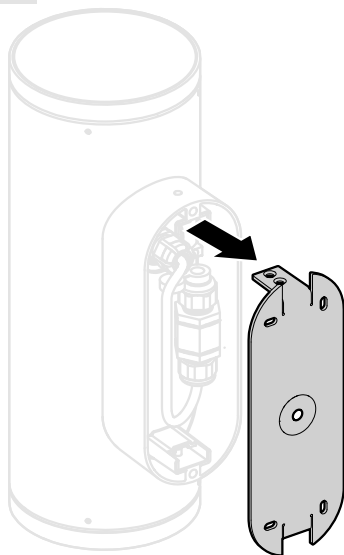

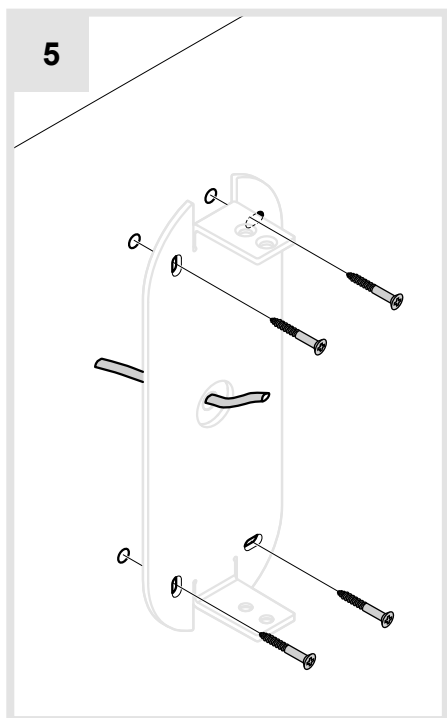
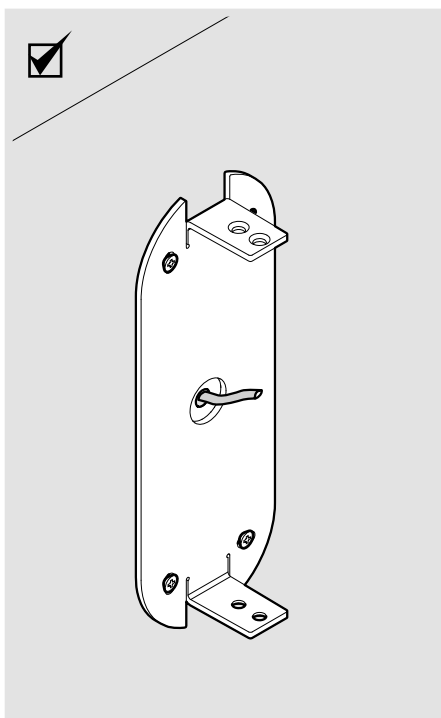
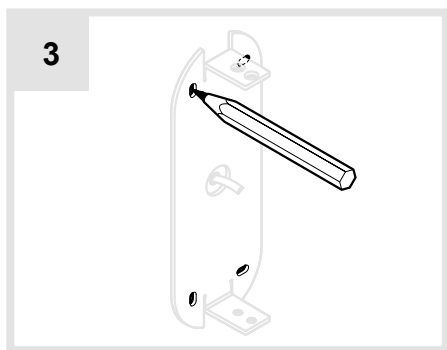
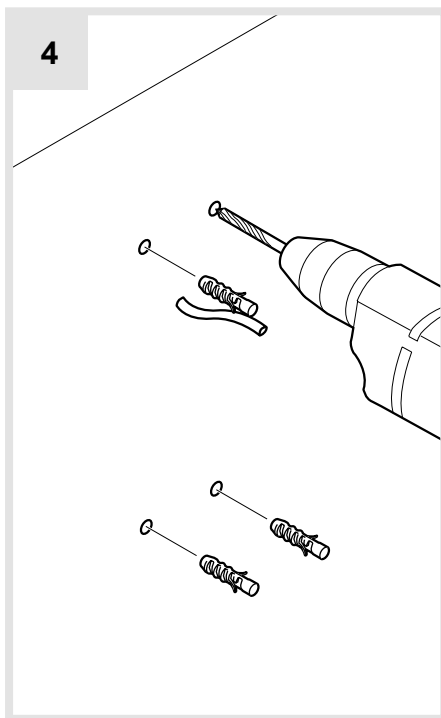
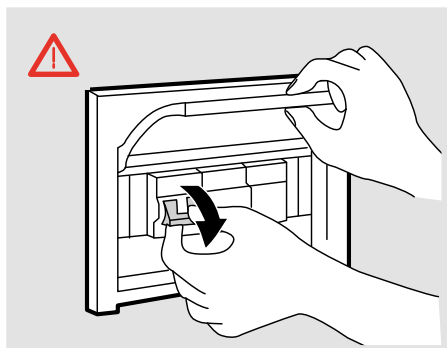

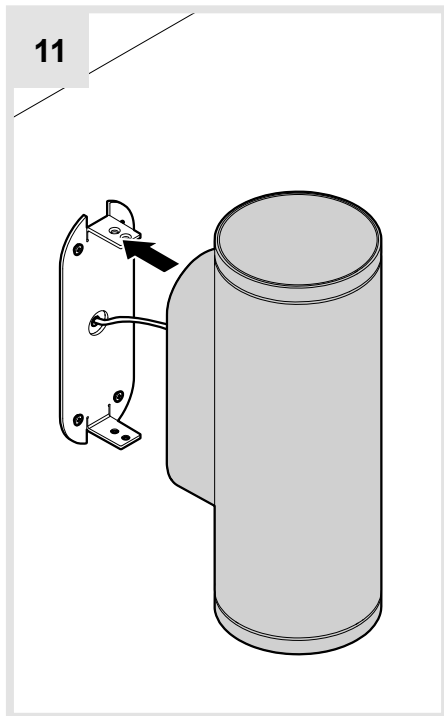
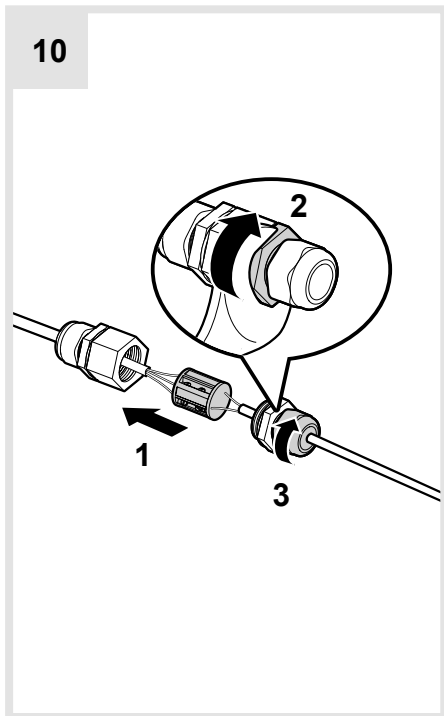
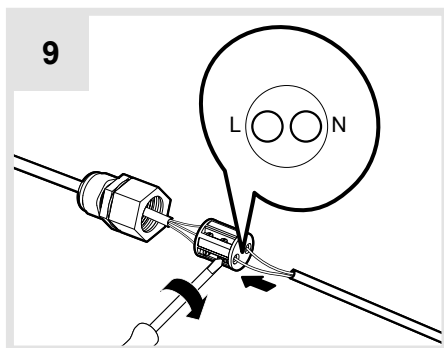
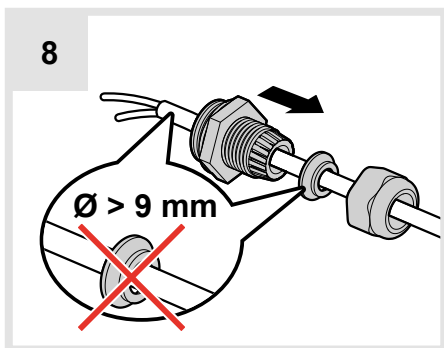
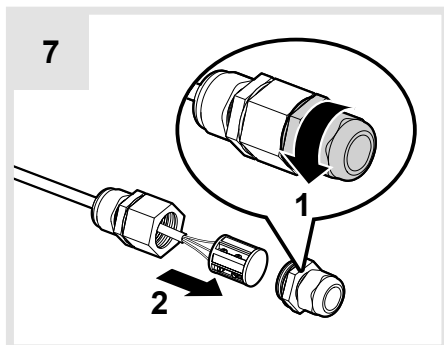
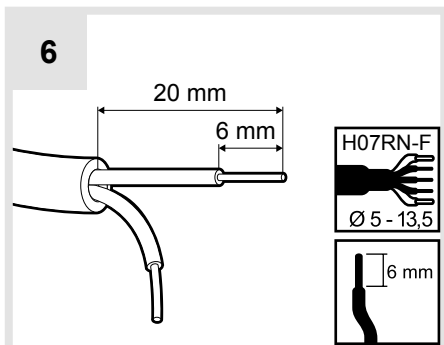

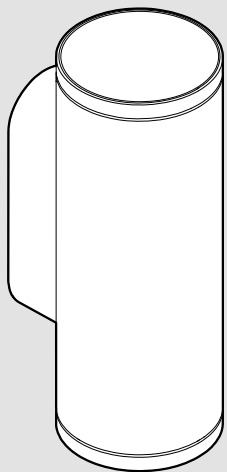
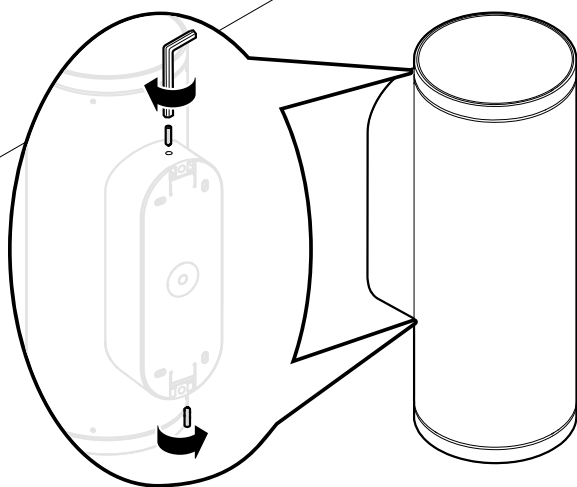

13

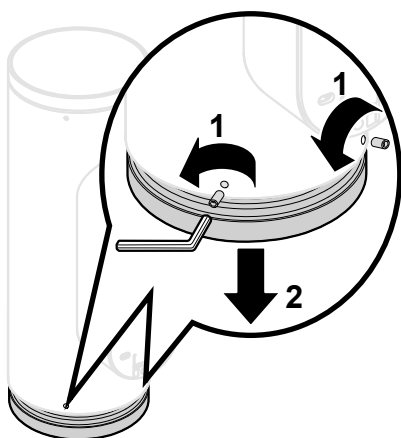

14

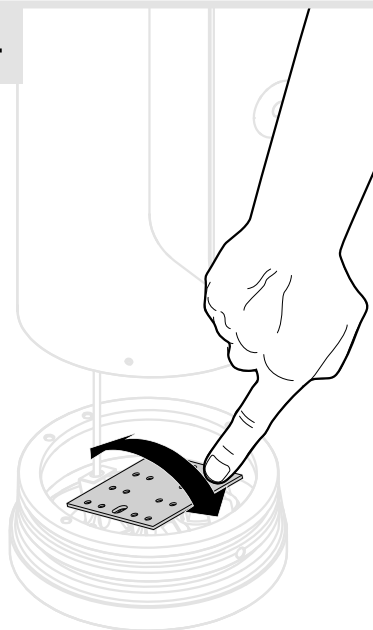

15

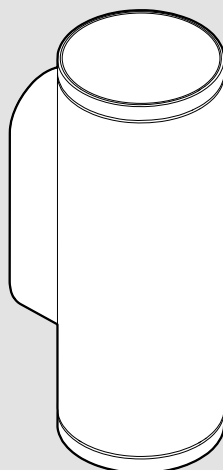



i

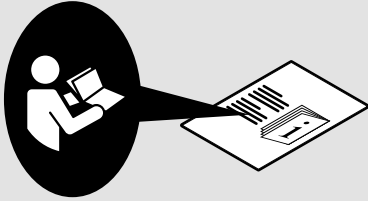

1







**Artemide®**

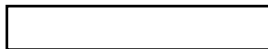

## **Artemide Spa**

via Bergamo, 18  
20006 Pregnana M.se (MI)  
ITALIA

Tel. +39 02 935 181  
Fax +39 02 935 90 254  
Fax +39 02 935 90 496

[www.artemide.com](http://www.artemide.com)

VAT IT00846890150

cod. Y513000052D